

Handling Guidelines for Working with SamplePro® FlexFilm Bags



skcinc.com

Form 38026 Rev 230213

- ☑ Do not overfill bags.

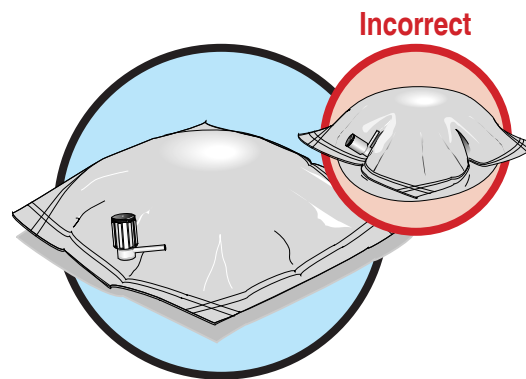

- ☑ Secure polypropylene valve when opening/closing by holding side stem while turning entire upper portion of fitting one revolution.
See how to properly open and close polypropylene fitting at <https://youtu.be/JTRTP-Vr7p8>.



- ☑ Store bags flat. Do not roll or crease bags during storage.

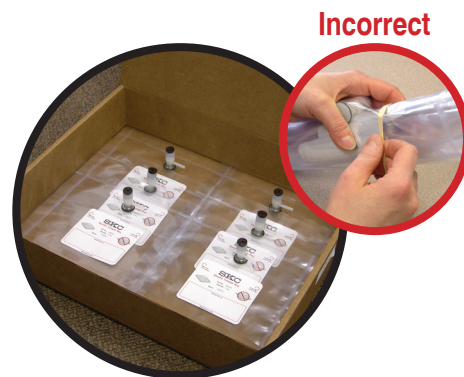

- ☑ Bags are designed for single use only.

